

ALGEMENE KENMERKEN:

Balg in EPDM of NBR

Flenzen in staal, verzinkt

 Temperatuurbereik: -10°C ~ 80°C (NBR)
 -10°C ~ 100°C (EPDM)

TOEPASSING:

- Waterdistributie, verwarming en HVAC (EPDM)
- Minerale olie, koolwaterstoffen en brandstof (NBR)

FIGUUR:

- S11A10E-0303: balg in EPDM, flenzen PN10

- S11A10B-0303: balg in NBR, flenzen PN10



| ONTWERP | |
|------------------------|--|
| Constructie | ISO 9001 : 2015 |
| Flenzen | EN 1092-2 PN10/16 |
| TESTEN EN CERTIFICATEN | |
| Kwaliteit | ISO 9001, CE-PED (vrijgesteld volgens art. 4.3 sound engineering practice) |

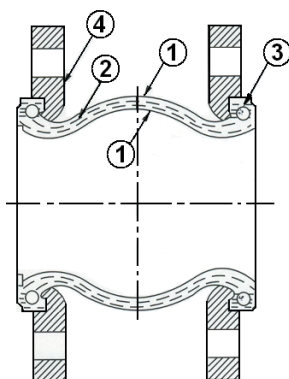

| N° | Omschrijving | Materialen | |
|----|------------------------|-----------------|--------------|
| | | S11A10E-0303 | S11A10B-0303 |
| 1 | Balg (binnen & buiten) | EPDM | NBR |
| 2 | Versteving | Nylon koord | |
| 3 | Klemring | Gehard staal | |
| 4 | Flenzen | Staal, verzinkt | |

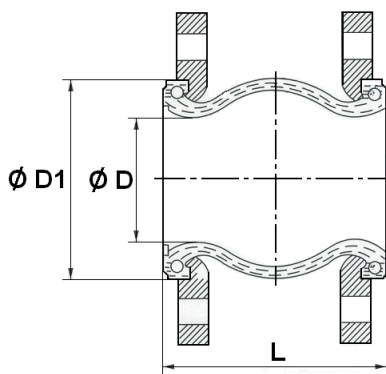

Afmetingen (mm):

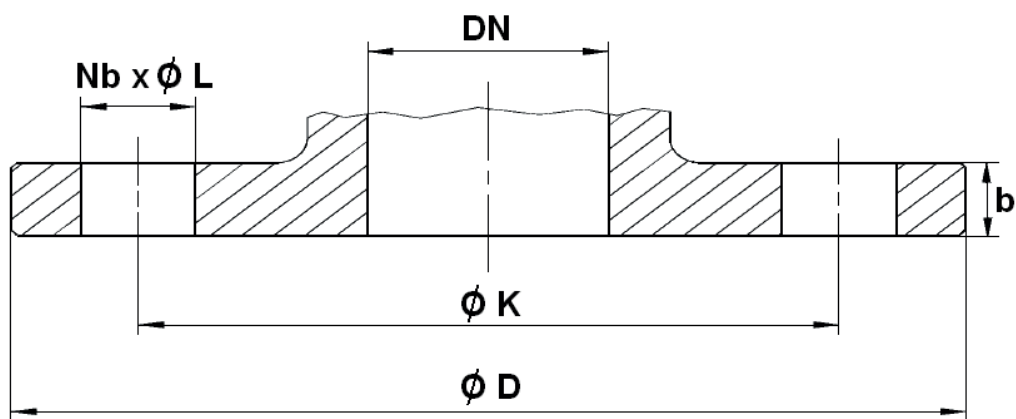
| DN | L | Ø D | Ø D1 | Kg (S11A10E-0303) | Kg (S11A10B-0303) |
|-----|-----|-----|------|----------------------|----------------------|
| 32 | 130 | 29 | 69 | 2,74 | 2,74 |
| 40 | 130 | 36 | 78 | 2,98 | 2,98 |
| 50 | 130 | 48 | 89 | 4,24 | 4,24 |
| 65 | 130 | 63 | 108 | 4,98 | 4,98 |
| 80 | 130 | 73 | 124 | 6,27 | 5,72 |
| 100 | 130 | 92 | 145 | 6,94 | 6,94 |
| 125 | 130 | 123 | 180 | 9,18 | 9,18 |
| 150 | 130 | 144 | 209 | 10,96 | 10,96 |
| 200 | 130 | 199 | 259 | 15,30 | 15,30 |
| 250 | 130 | 154 | 322 | 20,24 | - |
| 300 | 130 | 295 | 370 | 23,46 | - |

Afmetingen (mm):

| SA11A10E-0303 / SA11A10B-0303* | | | | |
|--------------------------------|-----|-----|----------|----|
| DN | Ø D | Ø K | Nb x Ø L | b |
| 32 | 140 | 100 | 4 x 19 | 14 |
| 40 | 150 | 110 | 4 x 19 | 14 |
| 50 | 165 | 125 | 4 x 19 | 15 |
| 65 | 185 | 145 | 4 x 19 | 15 |
| 80 | 200 | 160 | 8 x 19 | 17 |
| 100 | 220 | 180 | 8 x 19 | 17 |
| 125 | 250 | 210 | 8 x 19 | 19 |
| 150 | 285 | 240 | 8 x 23 | 19 |
| 200 | 340 | 295 | 8 x 23 | 20 |
| 250 | 395 | 350 | 12 x 23 | 22 |
| 300 | 445 | 400 | 12 x 23 | 22 |

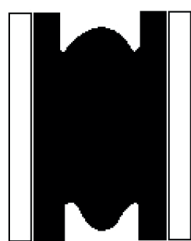
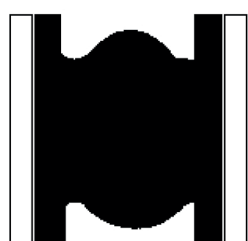
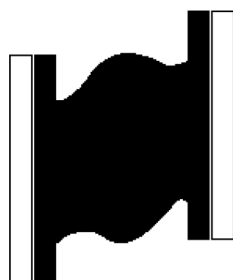
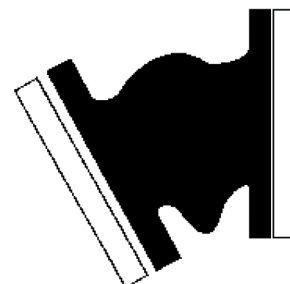
* SA11A10B-0303 enkel tot en met DN200

COMPRESSIE

EXPANSIE

LATERAAL

ANGULAIR
Beweging (mm):

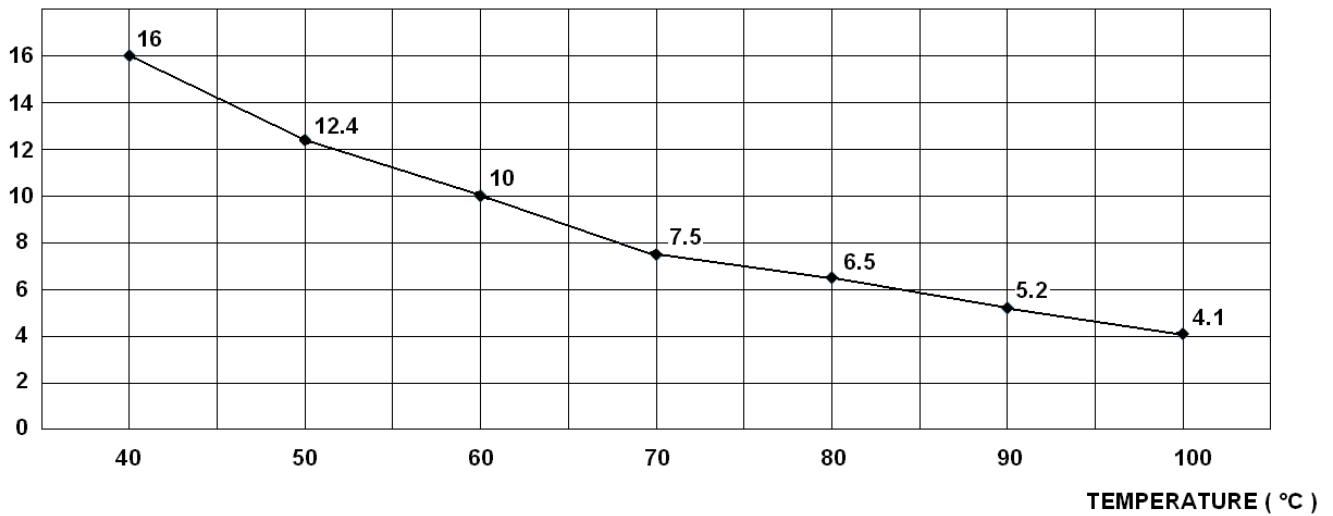
| DN | Compressie | Expansie | Lateraal | Angulair |
|-----|------------|----------|----------|----------|
| 32 | 12 | 10 | 12 | 15° |
| 40 | 12 | 10 | 12 | 15° |
| 50 | 12 | 10 | 12 | 15° |
| 65 | 12 | 10 | 12 | 15° |
| 80 | 12 | 10 | 12 | 15° |
| 100 | 12 | 10 | 12 | 15° |
| 125 | 12 | 10 | 12 | 15° |
| 150 | 12 | 10 | 12 | 15° |
| 200 | 12 | 10 | 12 | 15° |
| 250 | 12 | 10 | 12 | 15° |
| 300 | 12 | 10 | 12 | 15° |

PT*:

(Bar)

S11A10E-0303 (DN32 - DN300)

(Bar)

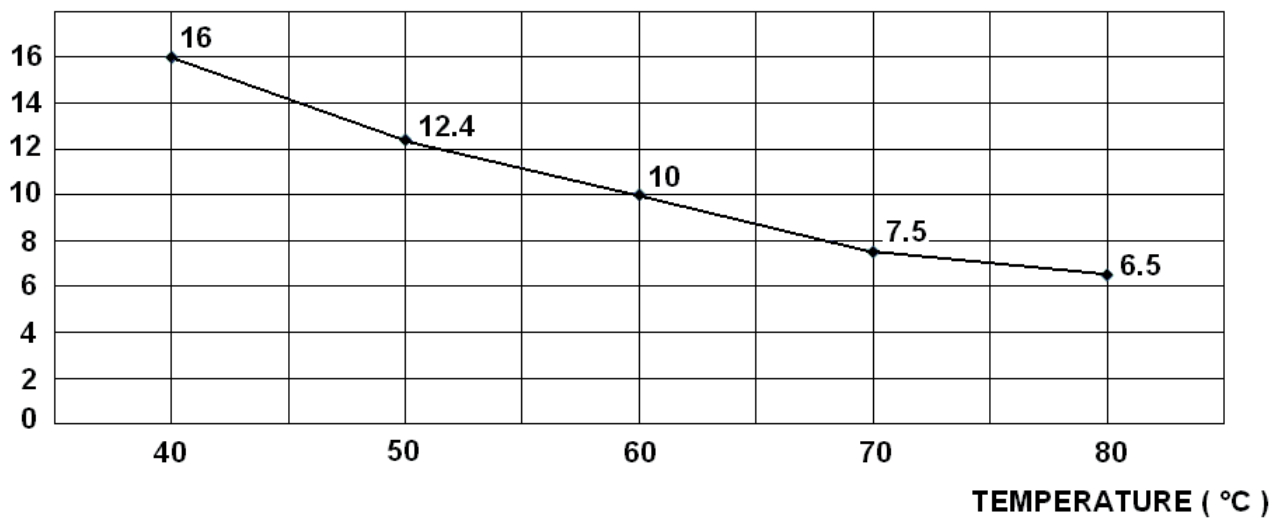
S11A10B-0303 (DN32 - DN200)

 * Bovenstaande waarden zijn NIET van toepassing op stoom