

**ALGEMENE KENMERKEN:**

Balg in EPDM of NBR

Flenzen in staal, verzinkt

 Temperatuurbereik:   -10°C ~ 80°C (NBR)  
                               -10°C ~ 100°C (EPDM)

**TOEPASSING:**

- Waterdistributie, verwarming en HVAC (EPDM)
- Minerale olie, koolwaterstoffen en brandstof (NBR)

**FIGUUR:**

- S10A10E-0303: balg in EPDM, flenzen PN10
- S10A16E-0303: balg in EPDM, flenzen PN16 (DN200 ~ DN350)
- S10A10B-0303: balg in NBR, flenzen PN10



ONTWERP	
Constructie	ISO 9001 : 2015
Flenzen	EN 1092-2 PN10/16
TESTEN EN CERTIFICATEN	
Kwaliteit	ISO 9001, CE-PED (vrijgesteld volgens art. 4.3 sound engineering practice)

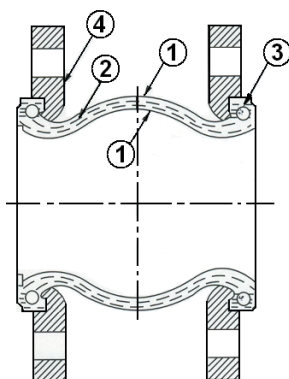

N°	Omschrijving	Materialen	
		S10A10E-0303 / S10A16E-0303	S10A10B-0303
1	Balg (binnen & buiten)	EPDM	NBR
2	Versteving	Nylon koord	
3	Klemring	Gehard staal	
4	Flenzen	Staal, verzinkt	

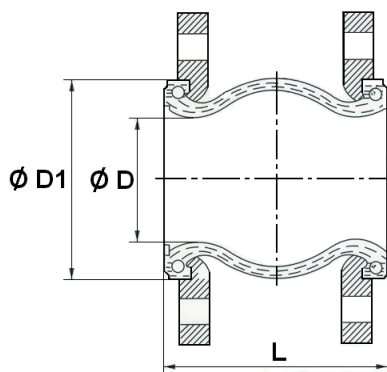
**Afmetingen (mm):**

DN	L	Ø D	Ø D1	Kg (S10A10E-0303)	Kg (S10A16E-0303)	Kg (S10A10B-0303)
32	95	29	69	2,79	-	2,95
40	95	37	79	3,59	-	3,46
50	105	47	90	4,23	-	3,98
65	115	57	108	4,74	-	4,89
80	130	74	124	6,27	-	6,57
100	135	91	145	6,47	-	6,74
125	170	119	179	9,40	-	9,36
150	180	145	209	12,75	-	12,71
200	205	199	261	17,73	17,87	16,80
250	240	241	320	23,27	26,00	-
300	260	294	370	29,40	33,13	-
350	265	331	420	41,30	-	-
400	265	372	473	46,85	-	-
450	200	431	532	55,18	-	-
500	200	486	587	65,00	-	-
600	250	591	685	74,50	-	-

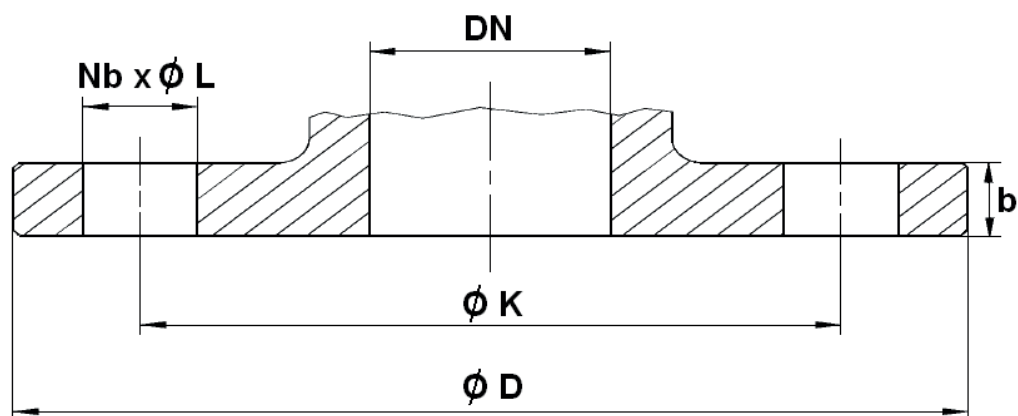
**Afmetingen (mm):**

PN10: SA10A10E-0303 / SA10A10B-0303*				
DN	Ø D	Ø K	Nb x Ø L	b
32	140	100	4 x 19	14
40	150	110	4 x 19	14
50	165	125	4 x 19	15
65	185	145	4 x 19	15
80	200	160	8 x 19	17
100	220	180	8 x 19	17
125	250	210	8 x 19	19
150	285	240	8 x 23	19
200	340	295	8 x 23	20
250	395	350	12 x 23	22
300	445	400	12 x 23	22
350	505	460	16 x 23	26
400	565	515	16 x 28	28
450	615	565	20 x 28	28
500	670	620	20 x 28	30
600	780	725	20 x 31	32

\* SA10A10B-0303 enkel tot en met DN200

PN16: SA10A16E-0303				
DN	Ø D	Ø K	Nb x Ø L	b
200	340	295	12 x 23	22
250	405	355	12 x 28	24
300	460	410	12 x 28	24

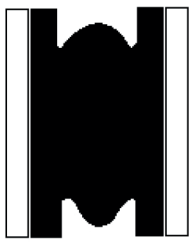
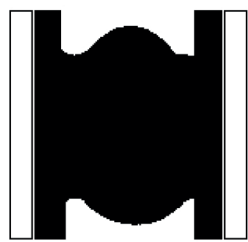
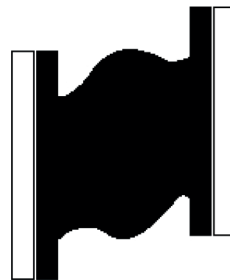
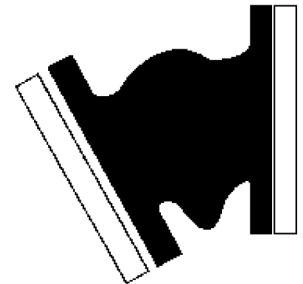
**COMPRESSIE**

**EXPANSIE**

**LATERAAL**

**ANGULAIR**
**Beweging (mm):**

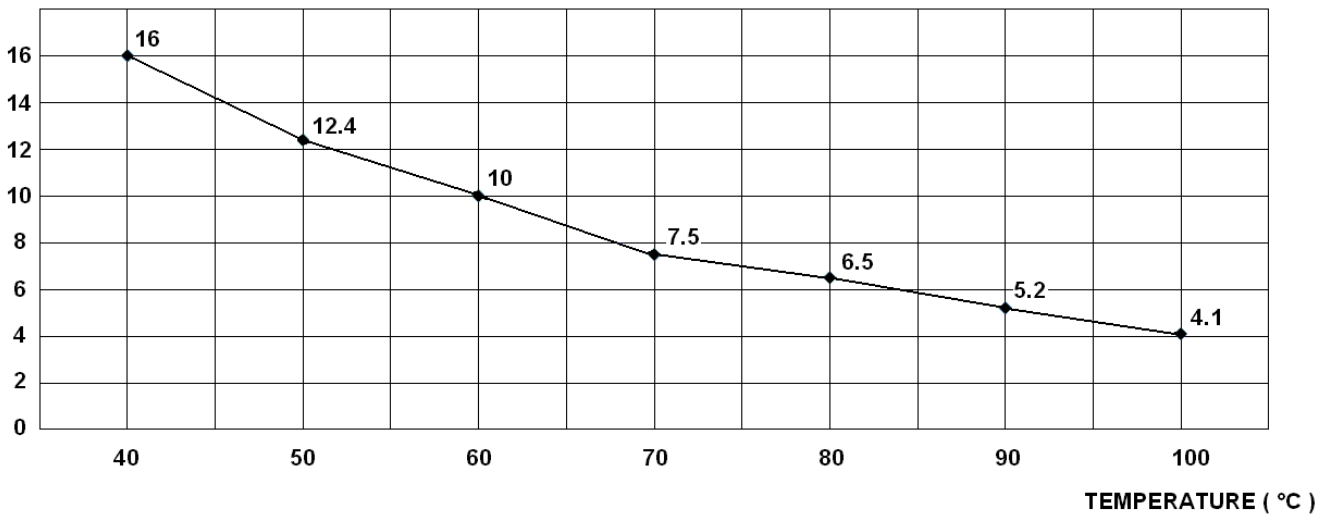
DN	Compressie	Expansie	Lateraal	Angulair
32	8	4	8	15°
40	8	4	8	15°
50	8	4	8	15°
65	12	6	10	15°
80	12	10	12	15°
100	18	10	12	15°
125	18	10	12	15°
150	18	10	12	15°
200	20	14	18	15°
250	22	14	18	15°
300	24	14	18	15°
350	25	16	18	15°
400	25	16	18	15°
450	20	12	18	15°
500	20	12	18	15°
600	20	12	18	15°

PT\*:

( Bar )

**S10A10E-0303 / S10A16E-0303 (DN32 - DN300)**

( Bar )

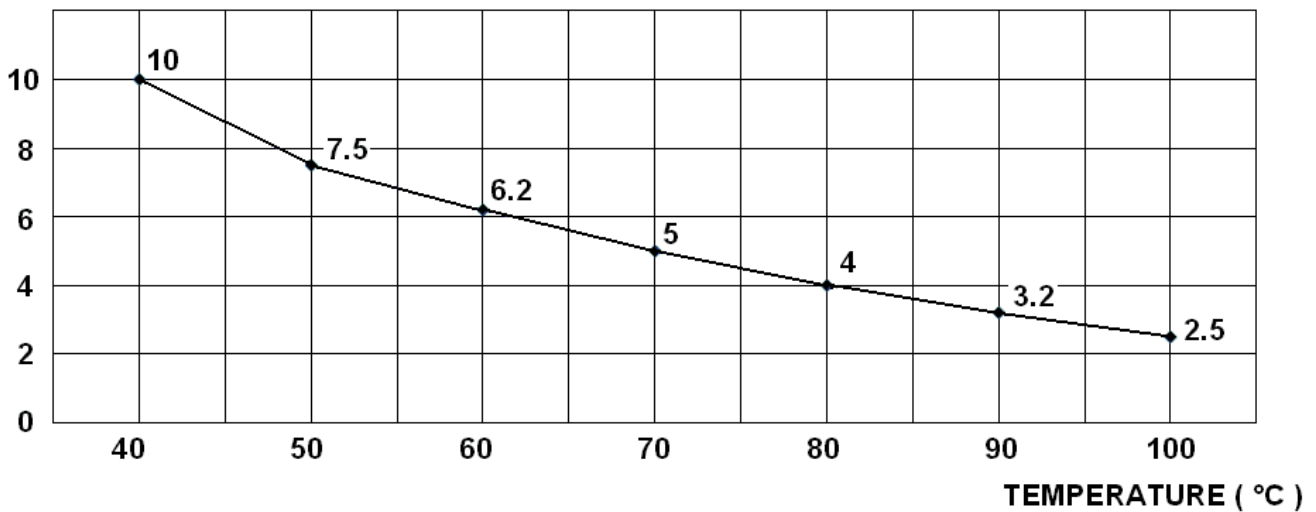
**S10A10E-0303 (DN350 - DN600)**

( Bar )

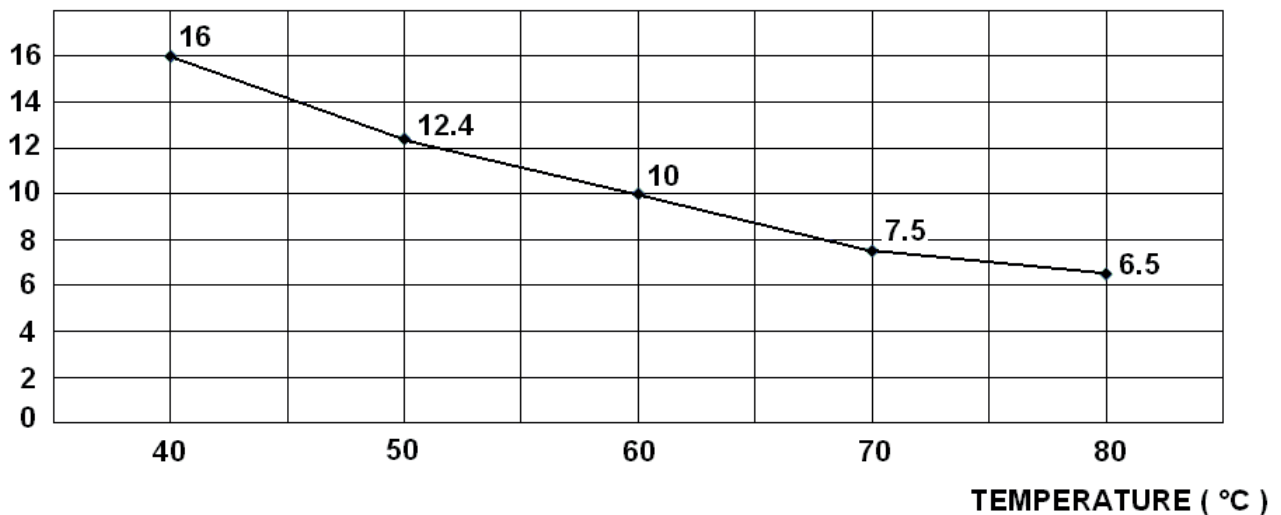
**S10A10B-0303 (DN32 - DN200)**

Wijzigingen voorbehouden

 \* Bovenstaande waarden zijn NIET van toepassing op stoom